

In2Flow Tracheostomy Connector

Technical Specifications

Technical performance and environmental requirements

Specification	PN 10076608
Patient group	Adult/Pediatric ¹
Maximum flow	60 (l/min)
Flow resistance at 60 l/min	2.5 (cmH ₂ O)
Connector to:	<ul style="list-style-type: none">• Tracheostomy interface (ID15)²• Breathing circuit (OD22)²
Oxygen concentration	21% to 100%
Operating time	14 days maximum or in accordance with hospital infection control procedures
Operating and storage temperature	18°C to 35°C (64°F to 95°F)
Operating and storage humidity	Less than 95% relative humidity, noncondensing
Transport temperature (maximum 4 weeks)	-10°C to 50°C (14°F to 122°F)
Compatible devices	Hamilton Medical ventilators with high flow oxygen therapy in combination with the HAMILTON-H900 humidifier or any other high flow oxygen therapy device

Standards and approvals

Classification	Class EU IIa (in accordance with MDD/MDR)
Intended use	The tracheostomy connector is a patient interface intended for the delivery of heated and humidified respiratory gases.
Intended users	The tracheostomy connector is intended for use by qualified, trained personnel.
Intended area of use	The intended areas of use are healthcare facilities (hospitals and long term acute care hospitals).
Declaration	<p>The tracheostomy connector was developed in accordance with pertinent international standards and FDA guidelines. The tracheostomy connector is manufactured within an EN ISO 13485 certified quality management system.</p> <p>The tracheostomy connector has been designed to comply with: Council Directive 93/42/EEC (MDD), Medical Device Regulation (MDR), ISO 5356-1:2015, ISO 10993-1:2018, ISO 14971:2019, EN 980:2008, EN 15223-1:2017, EN 1041:2008+A1 :2013, ISO 4135 :2001, and IEC 62366-1:2015.</p>

¹ The tracheostomy connector is intended for use with pediatric patients older than 2 years.

² Conforms to ISO 5356-1:2015.



Physical characteristics

Specification	PN 10076608
Delivery tube length (mm)	250 ± 15
Inner diameter (mm)	10.2 ± 0.5
Outer diameter (mm)	≤ 15
Material	<ul style="list-style-type: none"> T-Piece: ABS Sputum guard: PP
Additional information	Sputum guard: 360° rotatable, available as spare part, box of 20 (PN1009102) Single-use, MR-Safe

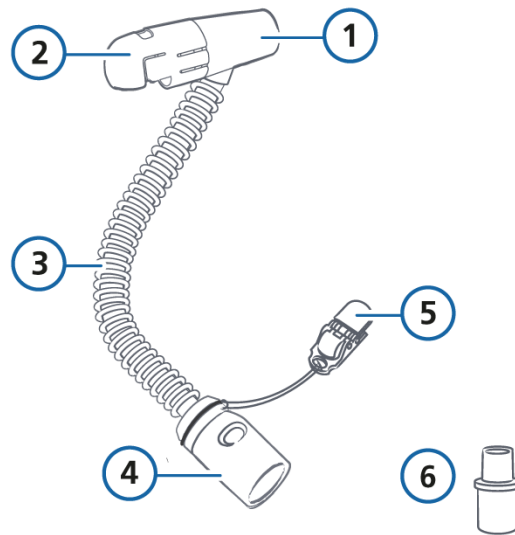
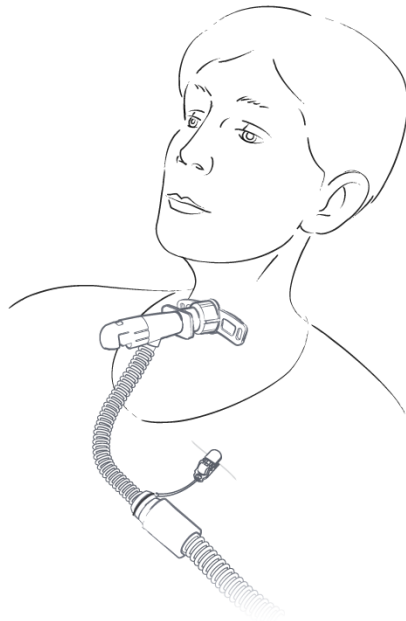

1	T-piece	4	Connection to inspiratory limb, OD22
2	Sputum guard	5	Securing clip
3	Delivery tube	6	Adapter, OD15

Manufacturer:

Hamilton Medical AG

Via Crusch 8, 7402 Bonaduz, Switzerland

☎ +41 58 610 10 20

✉ info@hamilton-medical.com

www.hamilton-medical.com

10108235/00

© 2020 Hamilton Medical AG. All rights reserved. Specifications are subject to change without notice. For all proprietary trademarks (®) and third-party trademarks (®) used by Hamilton Medical AG see www.hamilton-medical.com/trademarks.